

Quick Installation Guide

FullHD Wireless HD Set for HDMI

WHD030-V2



Receiver (RX)

Transmitter (TX)

Part 1 Package Content and Connectors

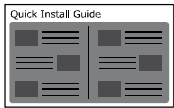

Quick Installation Guide

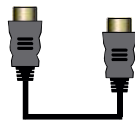

HDMI Cable x 1

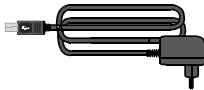

Mini-USB
Power Adapter x2



USB Cable
(for Transmitter)



Anchors x2
Screws x2

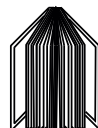

User's Manual

Rear View of Transmitter

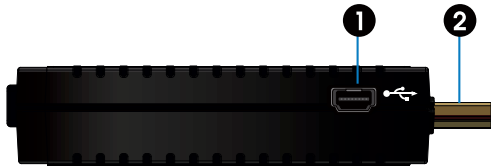

- 1 POWER IN
- 2 HDMI IN
- 3 DC IN
- 4 HDMI OUT

Rear View of Receiver

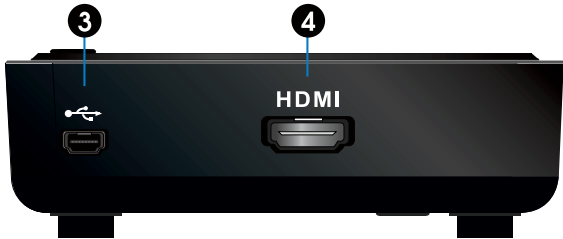

Part 2 Quick Installation Description

Hardware Installation

Transmitter Connections: Connect to PC via HDMI

- 1 Connect PC to WHD030-V2 TX (transmitter) by „HDMI IN“ port.
- 2 Connect the Mini-USB cable to the Transmitter and then to your PC.



Receiver Connections: Connect to HDTV via HDMI

- 1 Connect the „HDMI OUT“ port of the WHD030-V2 RX (receiver) to the „HDMI IN“ port of the HDTV with an HDMI cable.
- 2 Connect the power adapter to the receiver.



Quick Installation Guide

FullHD Wireless HD Set for HDMI

WHD030-V2

Part 3 Operation

Activate the WHD030-V2 and set up the link

Plug in the power for TX and RX, the WHD030-V2 set will establish the connection automatically.

When the power of the transmitter is plugged off for over 10 minutes, the receiver will enter Standby mode (Power LED of receiver will turn red).

When the receiver switches to Standby mode (PowerLED of receiver is red), plug in the power of transmitter and the transmitter will establish the connection automatically.



Please make sure the HDTV or HD-projector is already switched to the HDMI input connected to the receiver.

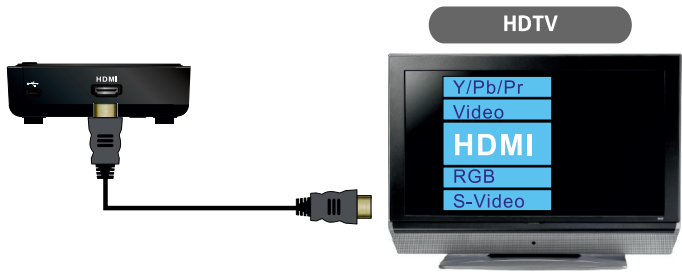

Make sure the display of your PC is set to be in „Duplicate“, „Extend“ or „Projector only“ mode for a signal on the external display.

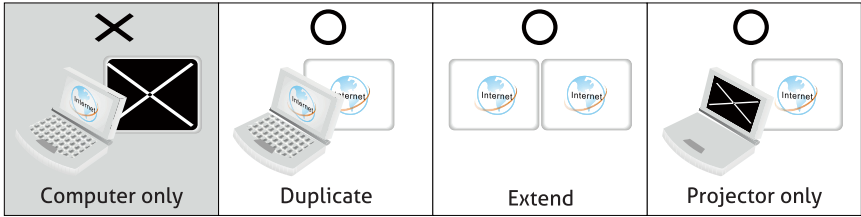

If the WHD030-V2 works normal, the POWER LED and SOURCE LED will be solid blue, and you can press the INFO button on the transmitter or receiver to check the status of signal quality and related information on the OSD. Press INFO key again to exit OSD.

